

Top-class, mobile surgical suction device
ATMOS Record 55 DDS



**Robust,
noiseless
and powerful!**



MedizinTechnik

ATMOS Record 55 DDS with autoclavable container system

ATMOS Record 55 DDS – the powerful allrounder!

The ATMOS Record 55 DDS is most suitable for the versatile use in OT due to the high suction performance and the high vacuum.

The ATMOS Record 55 DDS is the first choice when a noiseless and powerful suction system is required.

Approved technology make it a reliable system for many surgical applications:

- Visceral surgery
- Orthopaedic surgery
- Thorax surgery
- Vascular surgery, etc.

Particularly with regard to aesthetic-plastic surgery - especially the liposuction - the ATMOS Record 55 DDS is most suitable.

The ATMOS Record 55 DDS is now available in 2 Direct Docking versions:

**1. ATMOS Record 55 DDS –
with the reliable reusable
ATMOS container system**

**2. ATMOS Record 55 3DS –
the new disposable
ATMOS container system,
hygienic and easy to handle.
(in preparation)**

The advantages of the ATMOS Record 55 DDS at a glance:

- Powerful: The airflow rate of 55 litres per minute always provides a free vision in the operating field.
- Almost noiseless: Low operation noise for concentrated work in the OT.
- Easy handling
- Hygienic: Modern container systems and filters protect staff and patients.
- Reliable: Approved technology guarantees trouble-free operation.
- No breakdown caused by blocked bacterial filter
- Quick and safe reprocessing of the suction unit due to quick and easy to clean surfaces and very few corners and edges.



ATMOS Record 55 DDS

Details ATMOS Record 55 DDS



1 Hose connection
with twisted inlet, reduces foam formation and therefore, longer filter duration.



2 Quick exchange of bacterial filter
which has an extended filter surface.



3 Changeover lever
for comfortable selection of the collection jar during trolley operation.



Foot switch
anaesthesia-proof.

ATMOS Record 55 3DS¹⁾ disposable container system



**ATMOS Record 55
mit 3DS**

Details ATMOS Record 55 3DS



- 1** Standard rail holder
for fixing the universal
accessories.



- 2** Simplest handling
of the ATMOS 3DS
reusable container.



- 3** Changeover lever
for selecting of the
suction container.

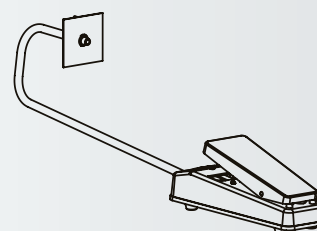

- 4** Foot switch (option)
for continuous
regulation of the
vacuum.

1)



This is how the ATMOS 3DS container system works:

Different to usual disposable container systems the ATMOS 3DS container system is not connected to the aggregate by means of a hose but with the approved Direct Docking technology. Here the adapter ring is fixed to the docking station of the ATMOS suction system - that's all! A fast exchange of containers and the mix up of connections or hoses is ruled out - this is ATMOS 3DS!

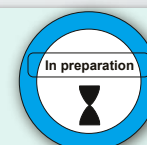

ATMOS Record 55 DDS ATMOS Record 55 3DS User packages

ATMOS Record 55 / DDS / 3DS

- User packages
- General accessories

- Top suction performance
- Almost noiseless
- Easy handling
- Short start-up time

These images also contain optional functions.



ATMOS Record 55 DDS with 2 x 3 l container



ATMOS Record 55 3DS with 2 x 3 l container



ATMOS Record 55 with standard rail



Silent, powerful and user-friendly The surgical suction device with maximum performance!

	REF
<p>ATMOS Record 55 DDS, with 2 x 3 l container</p> <p>Mobile surgical suction unit for very high demands; quiet running; infinitely variable vacuum control; damped vacuum display; change-over for container selection; for direct docking system containers; connection for footswitch; mains cable L = 5 m; air-flow rate of pump: 55 ± 3 l/min; vacuum -98 kPa/-735 mmHg at sea level; 230 V~, 50/60 Hz, dimensions (H x W x D): 940 x 500 x 390 mm</p> <ul style="list-style-type: none"> ■ 2 x DDS collection container 3 l, plastic ■ 2 x DDS container lid set ■ 10 x DDS-bacterial filter/oversuction stop ■ 1 x suction hose 	444.0930.0
<p>ATMOS Record 55 DDS with 2 x 5 l container</p> <p>Like above, but with 2 x 5 l container</p>	444.0940.0
<p>ATMOS Record 55 3DS with 2 x 3 l container</p> <p>Mobile surgical suction unit for very high demands; quiet running; infinitely variable vacuum control; damped vacuum display; change-over for container selection; for 3-DS containers; connection for footswitch; mains cable L = 5 m; air-flow rate of pump: 55 ± 3 l/min; vacuum -98 kPa/-735 mmHg at sea level; 230 V~, 50/60 Hz, dimensions (H x W x D): 940 x 500 x 390 mm</p> <ul style="list-style-type: none"> ■ 2 x 3DS secretion container 3 l ■ 2 x 3DS inner bag 3 l ■ 1 x suction hose 	444.0950.0
<p>ATMOS Record 55 with standard rail</p> <p>Mobile surgical suction unit for very high demands, specially suitable for subcutaneous liposuction, quiet running, infinitely variable vacuum control; damped vacuum display, bacterial filter with hydrophobe attributes (backup filter), standard rail 30 x 10 mm, suction hose L = 2 m, Ø 6 mm, suction hose L = 2 m, Ø 10 mm, mains cable L = 5 m; air-flow rate of pump: 55 ± 3 l/min; vacuum -98 kPa/-735 mmHg at sea level; 230 V~, 50/60 Hz, dimensions (H x W x D): 940 x 500 x 390 mm</p>	443.0700.0





Accessories for all ATMOS Record 55 User packages

OT
suction systems

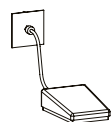

①

Accessories for all ATMOS Record 55 User packages

REF

① **Foot switch installation set for ATMOS Record 55 (foot bellows and installation set)** **443.0755.0**

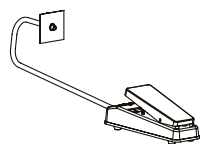

②

② **Foot regulator set for ATMOS Record 55 and ATMOS Record 55 DDS** **443.0770.0**

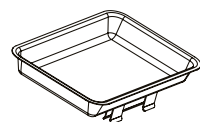

③

③ **Deposit tray, stainless steel, with holder for rail system** **443.0790.0**

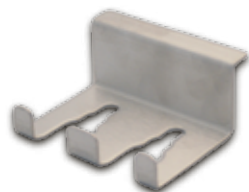

④





④ **Hose support, stainless steel, for attaching to standard rail** **320.0611.0**

DDS adapter for tissue collector **340.0062.0**

Accessories for ATMOS Record 55 DDS and ATMOS Record 55 3DS

ATMOS Record 55 DDS
ATMOS Record 55 3DS





- Accessories
- Consumables

	REF
Accessories for ATMOS Record 55 DDS	
① 	340.0050.0
DDS collection container, plastic, 1,5 l height 247 mm, external-Ø 166 mm	
DDS collection container, plastic, 3 l height 247 mm, external-Ø 166 mm	340.0051.0
DDS collection container, plastic, 5 l height 396 mm, external-Ø 166 mm	340.0052.0
DDS collection lid complete	340.0040.0
consisting of:	
■ DDS jar lid	
■ DDS jar handle	
■ DDS splash protection	
■ DDS hose adapter set, Ø 6 mm + Ø 10 mm	
■ DDS bacterial filter / oversuction stop	
■ hose holder on DDS-jar	
② 	340.0053.0
DDS container lid with gaskets	
DDS container handle, PSU, blue	340.0055.0
DDS splash protection	340.0056.0
DDS hose adapter set Ø 6 mm + Ø 10 mm	340.0057.0
DDS hose container support	340.0066.0
Consumables for ATMOS Record 55 DDS	
③ 	340.0054.0
DDS bacterial filter/oversuction stop, hydrophobic, disposable, not autoclavable, 10 pcs., 50 pcs., 100 pcs., Change: 1 x per patient	
 Suction hose, silicone, Ø 6 mm, L = 2 m, (136 °C) Change: after 20 x autoclaving	000.0361.0
Suction hose, silicone, Ø 10 mm, L = 2 m, (136 °C) Change: after 20 x autoclaving	000.0243.0
Suction hose, disposable, Ø 6 mm, L = 2,10 m, not autoclavable, 50 pcs, Change: 1 x per patient	006.0059.0 *
Consumables for ATMOS Record 55 3DS	
ATMOS 3DS external container 1 l	312.1170.0
④ ATMOS 3DS external container 2 l	312.1171.0
ATMOS 3DS external container 3 l	312.1172.0
⑤ ATMOS 3DS adapter ring	312.1166.0
Consumables for ATMOS Record 55 3DS	
 ATMOS 3DS inner bag 1 l	312.1180.0
⑥ ATMOS 3DS inner bag 2 l	312.1181.0
ATMOS 3DS inner bag 3 l	312.1182.0



Accessories for ATMOS Record 55 standard rail

OT
suction systems

	REF
Accessories for ATMOS Record 55 standard rail	
① 	Receptal® jar set, 2 l 444.0021.0 consisting of: <ul style="list-style-type: none"> ■ Receptal® holder complete ■ container for Receptal® suction bags 2 l ■ 1 Receptal® suction bag 2 l, with integrated overflow valve filter ■ 1 Receptal® suction bag 2 l, without overflow valve filter ■ DDS standard rail adapter with vacuum connection ■ connecting hose, L = 31 cm
② 	Receptal® jar set, 2 x 1.5 l 444.0022.0 consisting of: <ul style="list-style-type: none"> ■ Receptal® holder complete ■ 2 containers for Receptal® suction bags 1.5 l ■ 1 Receptal® suction bag 1.5 l, with integrated overflow valve filter ■ 1 Receptal® suction bag 1.5 l, without overflow valve filter ■ connecting hose, L = 12 cm
③ 	Receptal® external container 1,5 l 310.0221.0
④ 	Receptal® jar set 2 x 2 l 444.0023.0 consisting of: <ul style="list-style-type: none"> ■ Receptal® holder complete ■ 2 containers for Receptal® suction bags 2 l ■ 1 Receptal® suction bag 2 l, with integrated overflow valve filter ■ 1 Receptal® suction bag 2 l, without overflow valve filter ■ connecting hose, L = 12 cm
⑤ 	Receptal® external container 2 l 443.0256.0 Receptal® jar set 2 x 3 l 444.0024.0 consisting of: <ul style="list-style-type: none"> ■ Receptal® holder complete ■ 2 containers for Receptal® suction bags 3 l ■ 1 Receptal® suction bag 3 l, with integrated overflow valve filter ■ 1 Receptal® suction bag 3 l, without overflow valve filter ■ connecting hose, L = 12 cm
	Receptal®-external container 3 l 444.0157.0
	Single-Docking-Station 320.0810.0 for using of the ATMOS DDS- or 3DS container systems at the standard rail.

- Basic unit
- Technical Data
- Accessories

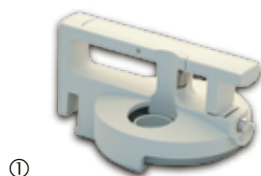

①



②



③



④



	REF
Accessories for ATMOS Record 55 standard rail	
① Secretion jar lid incl. standard rail holder	444.0650.0
② Socket nipple set comprising double socket nipple, hose reducer and mechanical overflow safety	444.0640.0
grad. secretion jar 1.5 l, glass, height 192 mm, Ø 115 mm	444.0032.0
Container jar 1.5 l, plastic, sterilisable up to 136°C	444.0036.0
③ grad. secretion jar 3 l, glass, height 247 mm, Ø 145 mm	444.0033.0
Container jar 3 l, plastic, sterilisable up to 136°C	444.0037.0
grad. secretion jar 5 l, glass, height 302 mm, Ø 169 mm	444.0034.0
Container jar 5 l, plastic, sterilisable up to 136°C	444.0038.0
DDS Safety jar 250 ml with integrated DDS-bacterial filter oversuction stop, incl. adapter (for arthroscopy, oral, and maxillofacial surgery, liposuction etc.)	444.0646.1
Consumables for ATMOS Record 55 standard rail	
Suction hose, silicone, Ø 10 mm, L = 2 m, (136 °C) Change: after 20 x autoclaving	000.0243.0
Suction hose, silicone, Ø 6 mm, L = 2 m, (136 °C) Change: after 20 x autoclaving	000.0361.0
Suction hose, disposable, Ø 6 mm, L = 2.10 m, not autoclavable, 50 pcs. Change: 1 x per patient	006.0059.0 *
Receptal® 1.5 l, suction bags, w. integr. overflow valve filter, not autoclavable, 50 pcs. Change: 1 x per patient	310.0222.2 *
Receptal® 2 l, suction bags, w/o. integr. overflow valve filter, not autoclavable, 50 pcs., Change: 1 x per patient	443.0257.0 *
Receptal® 2 l, suction bags, w. integr. overflow valve filter, not autoclavable 50 pcs., Change: 1 x per patient	443.0257.2 *
Receptal® 3 l, suction bags, w/o. integr. overflow valve filter, not autoclavable, 50 pcs. for tandem hose connection Change: 1 x per patient	444.0153.0 *
Receptal® 3 l, suction bags, w. integr. overflow valve filter, not autoclavable 50 pcs., Change: 1 x per patient	444.0154.0 *
④ Medi-Vac® internal container 1 l, 50 pcs., Change: 1 x per patient	312.0474.0 *

Technische Daten	ATMOS Record 55 DDS
Air flow rate of pump:	55 l/min (± 3 l/min)
Max. vacuum at sea level:	-98 kPa (-980 mbar / -735 mmHg)
Power consumption:	approx. 100 W
Voltage:	230 V~ 50-60 Hz; Special voltage: 100 - 127 V~ 50-60 Hz;
Noise level:	46 dB (A) @ 1 m (acc. to ISO 7779)
Operating time:	continuous operation
Ambient conditions: during operation	10...+32 °C; 20...80 % air humidity without condensation; air pressure 700...1060 hPa
Dimensions (H x W x D):	940 x 500 x 390 mm, without collection jar
Weight:	36 kg, without collection jar
Classification:	degree of protection: type BF; protection category: IPX1; protection class: I; class IIa (acc. to appendix IX, directive 93/42/EEC)

The stated technical data are valid at the moment of printing, subject to technical alterations!